

@agostinigroup

introduces

MINIMAL DESIGN SOLUTIONS

MINIMAL FRAMES SYSTEM

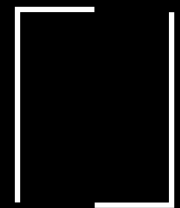





According to Agostini, minimal design windows and doors are about a new way of conceiving living situations through understated simplicity.

Space takes centre stage, portrayed in its purity, flooded with light. To complete the range of minimalist solutions in the Sliding and Pivot types, Agostini has chosen the Minimal Frame System, integrating the proven technology of the system with an attention to detail, design flexibility and all the quality of a fully Italian-made production.

The Minimal Frame System does away with all superfluous details, leaving a clear view of the outdoor spaces while giving a unique, exclusive design. All of this without foregoing highest performance in thermal and sound insulation, and in safety.



Why choose our solutions minimal frames

PLUS

- Minimal visual impact
- Unique and exclusive design
- Smooth sliding
- Maximum water resistance
- Fibex Inside
- Automations
- Certified excellence

TECHNICAL FEATURES

- Solutions
- Configurations
- Combinations
- Finishes
- Technical drawings

Minimal visual impact

With Agostini's Minimal Frame System, space takes centre stage: the visual impact of the door-and-window profiles is reduced to a bare minimum, even in the large windows.

_Surround frame fully-flush.

_Pane surround exposed only 4 mm (30 mm on the underside of the ZERO model)

_Central frame structure with a range from 24 mm (in the smallest solutions) to 30 mm (in the largest solutions) up to 45 mm (in those larger than 10 sq.m of single pane)

In the ONE model, the sash is visible only for 4 mm even in the lower part, sliding on the open frame; in the ZERO model, the sash is visible for 30 mm in the lower part but the frame disappears from view, giving continuity to the floor, with a minimum gap of just 10 mm.

Our technical solutions create doors and windows of surprising visual appeal, with large sliding doors of up to 12 sq.m, weighing up to 800 kg despite using minimal jamb-section profiles.



Only 4 mm of sash profile visible at the surround
and only 24 mm of vertical sash profile along the central mullion.

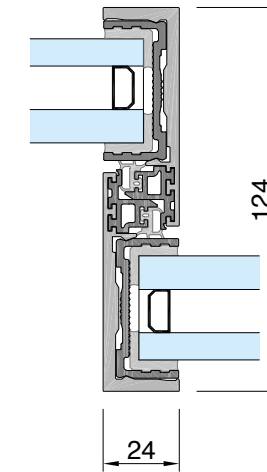

Central frame (24-30-45mm)

Minimum dimensions of vertical profile

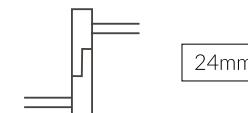

Maximum door height/width

Depending on the central frame structure,
window width and wind pressure

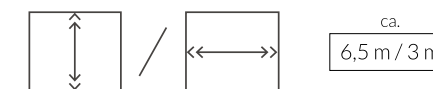

Unique and exclusive design solutions

The Minimal Frame System by Agostini is unique and exclusive also in its aluminium components.

_Closing handle with contemporary design, functional to ensure maximum protection and security. Painted to match the profile, to integrate with the frame and no longer be seen as something extra. Can be installed in the side closing handle or in the central frame profile.

_Handle bar with a minimal design, painted in the same colour to integrate into the frame, useful for moving the sashes to certain specific positions;

_External pull-handle for easy sliding with minimalist design, made of painted aluminium matching the frame (H=25mm), supplied on request.

_Attention to detail with the elegant casings with exclusive knurled finish on the floor, and smooth finish on the three boundary sides.

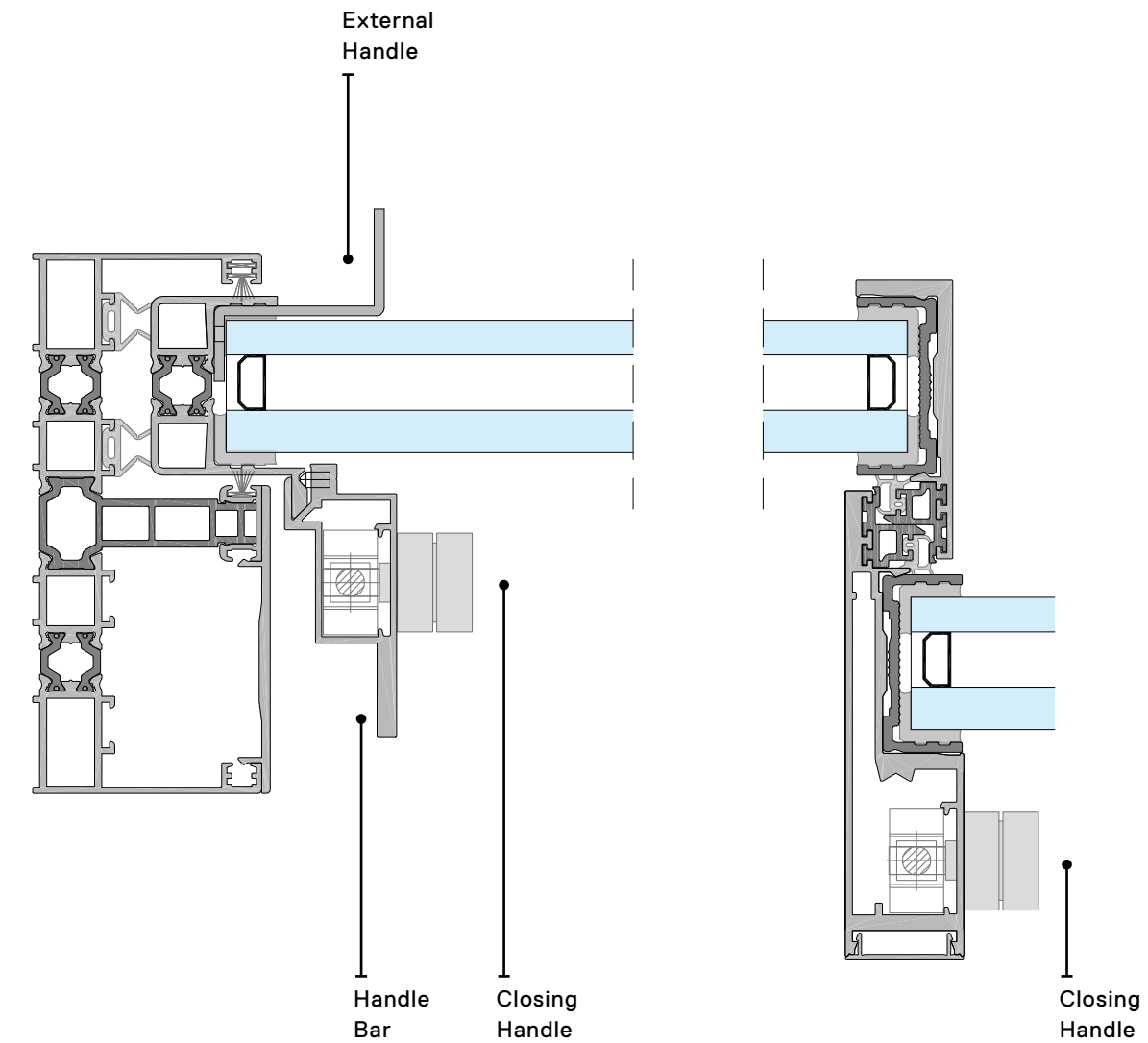





Smooth sliding

Agostini's Minimal Frame System are also exclusive in how they move:

the door sashes glide along stainless-steel tracks with special dollies (also in stainless steel) with a double wheel on each side of the door (the number of dollies is increased for doors weighing over 350 kg). This allows each sash to slide on at least eight wheels in a way that is muffled, almost silent. This system is also available with a motor drive, and can be integrated with home-automation solutions.

The high-resistance stainless steel dollies are installed directly in the door to facilitate maintenance and cleaning, which can be done with a normal vacuum cleaner.

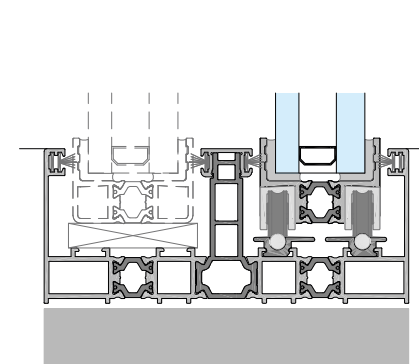

"ONE" model track

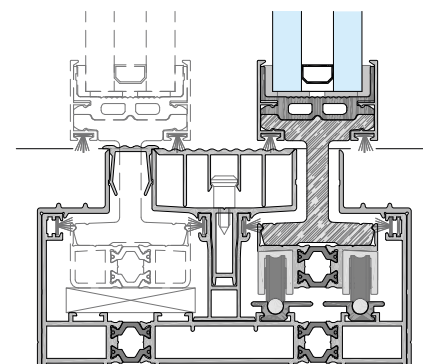

"ZERO" model track



Maximum impermeability

Agostini's Minimal Frame System is designed for the frame to be completely recessed, also in the lower guide. The rainwater that penetrates its interior drains away easily along ducts on a lower profile of insulating water-repellent material, and then leaves from the front part.

If there is a floating type of floor outside the doors, the water flows onto the external sheathing underneath. If instead the flooring is traditional, the lower frame includes a water-collection channel (stainless steel or aluminium) with drainage outlets to connect to the building's drainage channels.

To optimize water drainage in situations of particular exposure to the weather, you can opt for the solution of an external aluminium grid.

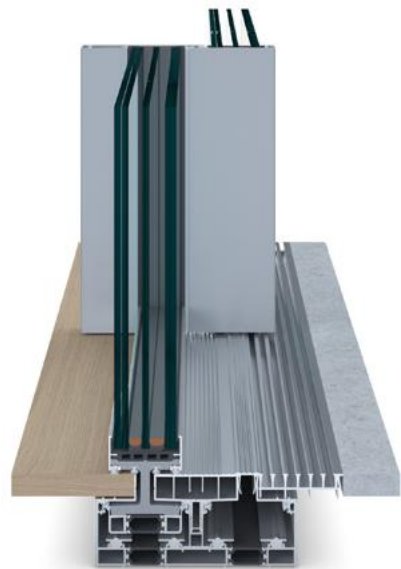

"ZERO" model with external drainage grid

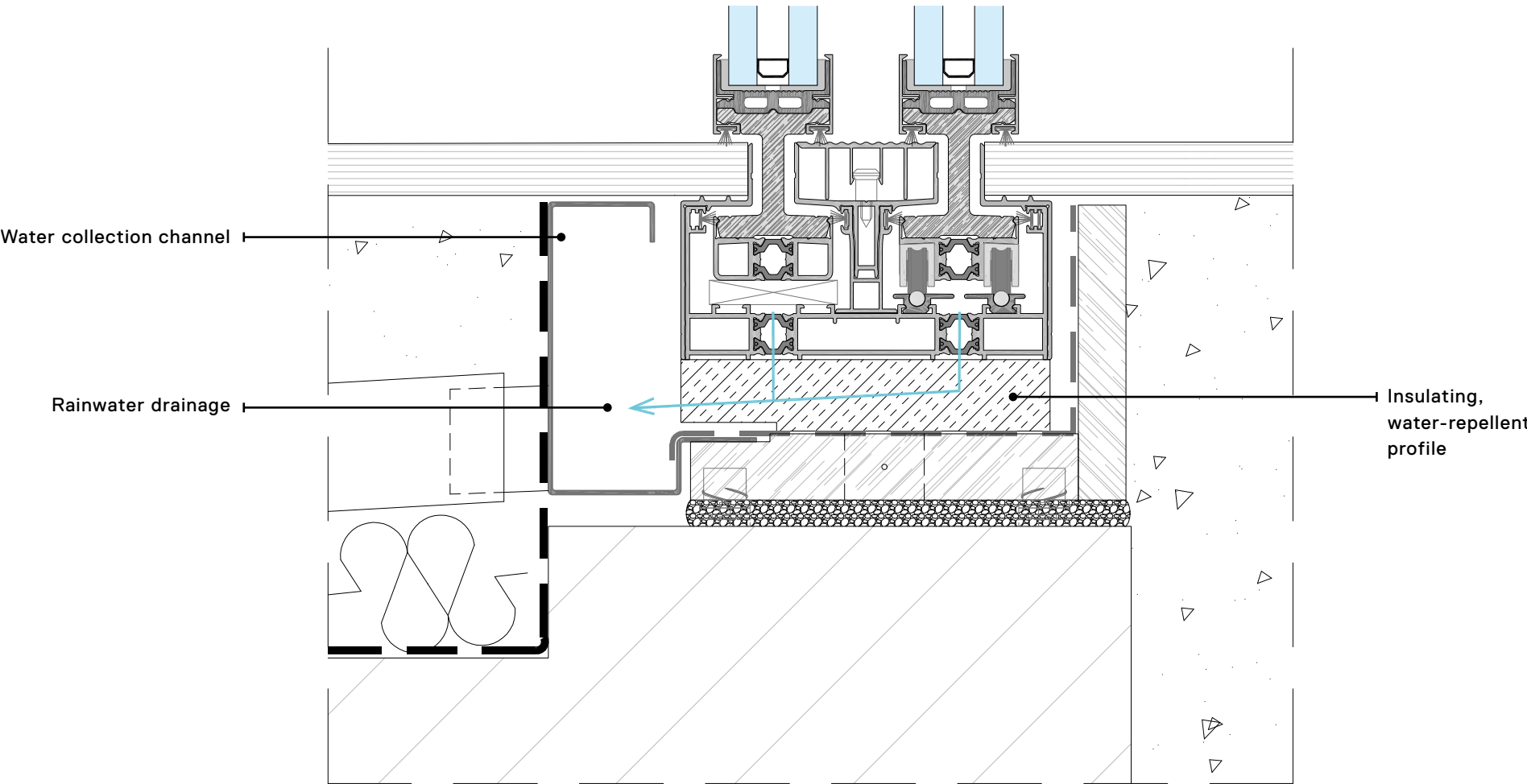

"ZERO" model with water drainage tray

Agostini and Fibex, the power of innovation

The term FRP Fiber Reinforced Polymer refers to all composite materials which are usually made up of a core matrix and a fibre. Not all fibres are the same and different fibres such as Kevlar, Carbon, and Glass fibre are used, depending on requirements.

FIBEX is a composite material made of unidirectional unbroken glass fibres (Roving) wrapped in a multi-directional fibre Mat and impregnated with polyester resin. The industrial process of making Fibex profiles is called pultrusion (a process of extrusion under traction).

Compared to traditional materials, the favourable ratio between strength and weight of the composite product lies behind its growing success and applications.

Agostini uses the Fibex composite as an innovative insulating material in our ZERO mode. The material's incredibly low thermal conductivity brings unparalleled results in thermal insulation.

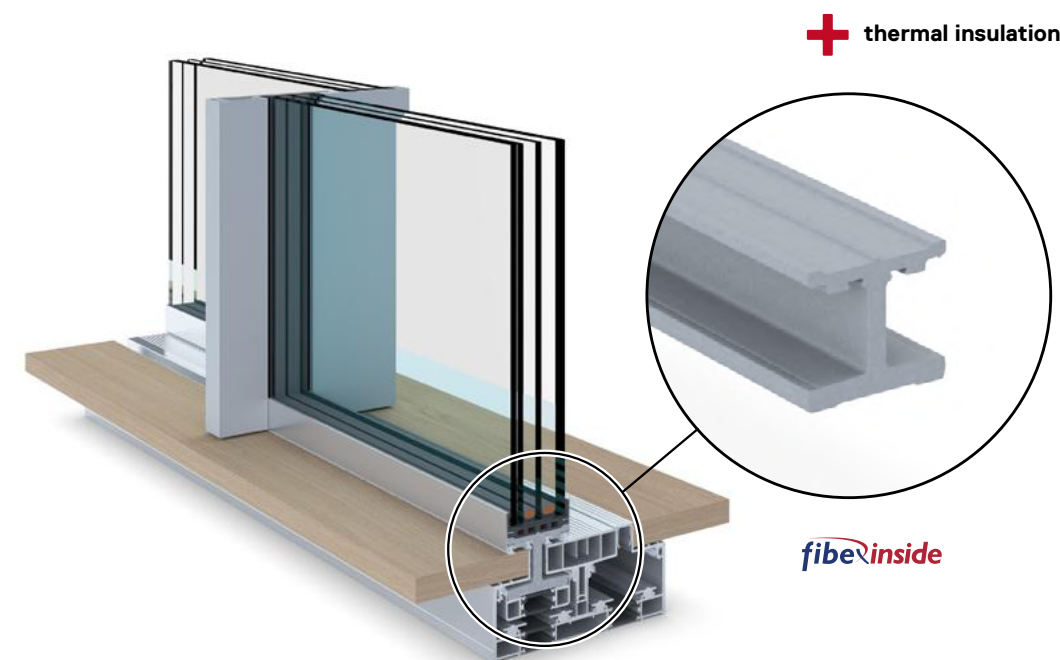

Automations

The sliding doors can be fitted with automated opening and closing solution. The fully-concealed drive is the ideal system for contexts requiring large, perfectly-functional and convenient surfaces. It is recommended for doors weighing more than 500 kg.

Motor-driven systems have many advantages:

_Design even more minimalist due to the absence of handles.

_Security with the irreversible gear-motor and integration with the alarm system and 'door closed' feedback.

_Simplicity from moving heavy doors with slow movement.

_Practicality and convenience by using radio controls, wi-fi modules or home automation.

For countries with specific safety regulations, the systems are always supplied with all the infra-red detection sensors for people-protection.

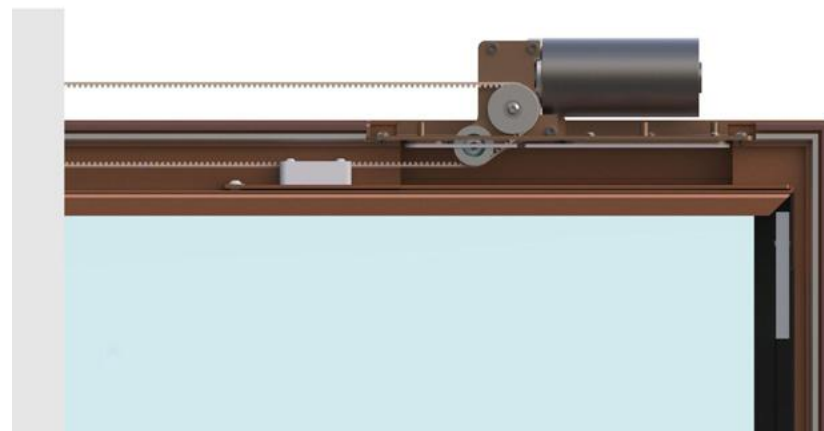

Certified excellence

Agostini's Minimal Frame System model is the ultimate match between minimalist design and performance, backed up by certifications and installations worldwide.

Unparalleled security

The locking system, with its handle-controlled hardware, uses special rods that move up and down simultaneously, to then lock in special aluminium housings. In the event of a break-in attempt, the doors, which are specially recessed into the frames, cannot be lifted out. The whole locking system is certified in RC2 in the "ONE" model and Sliding-Fixed configuration.

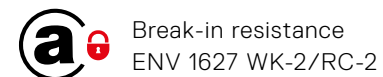
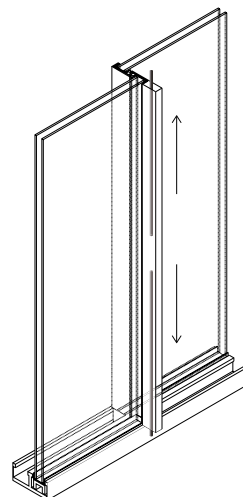

Break-in resistance
ENV 1627 WK-2/RC-2

Thermal and sound insulation

Agostini's Minimal Frame System have thermal-break profiles. Plus, we can also mount double glazing to reach even higher thermal insulation levels. With the ZERO model, the sash support fin is made of FIBEX composite material to minimize the system's conductivity also in the bottom main frame.



Uw values
up to 0.7 W/m²K (with triple glazing)



Sound insulation
up to 45 dB





Solutions ONE and ZERO

The Agostini Minimal Frame System come in two different frame solutions for the lower track.

With the classic **ONE** model series, the door sash is visible for just 4 mm also in the lower track and glides along the open frame.

For each sliding sash, the lower guide width varies from 50 (Omicron model) to 70 mm (Omega model), and remains visible when the sash is open.

With the **ZERO** model, instead, the door is 30 mm visible only on the lower side but the frame “disappears” from view, giving continuity to the floor, with a minimum gap of only 10 mm.

The superb aesthetics are further enhanced by the solutions with three, four or more dollies. The middle part between the doors can be made with a closed aluminium profile or with the floor itself, for best visual results.

With the ZERO model, the sash support fin is made of FIBEX composite material to minimize the system’s conductivity also in the bottom main frame.

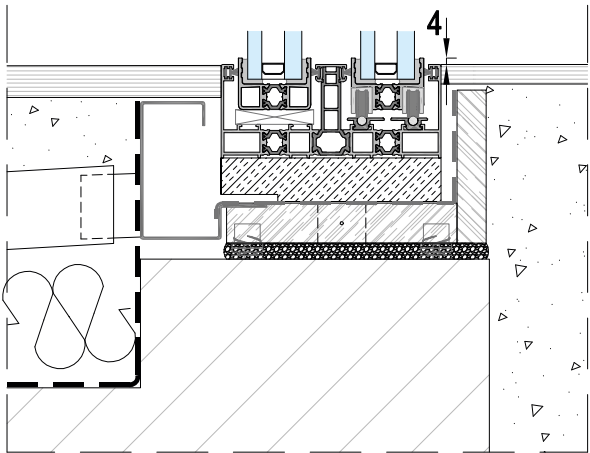

Track of the “ONE” model

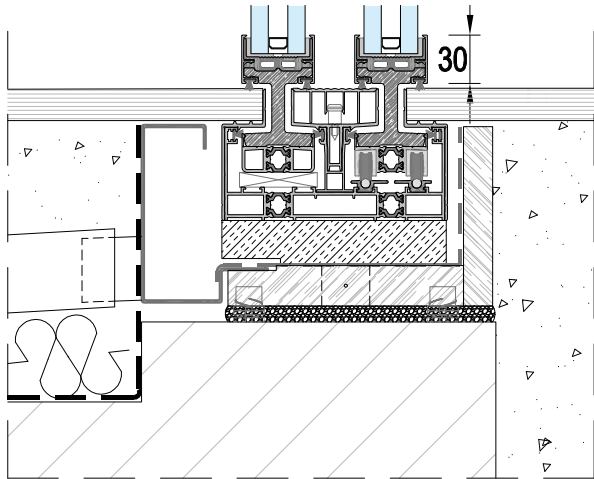

Track of the “ZERO” model

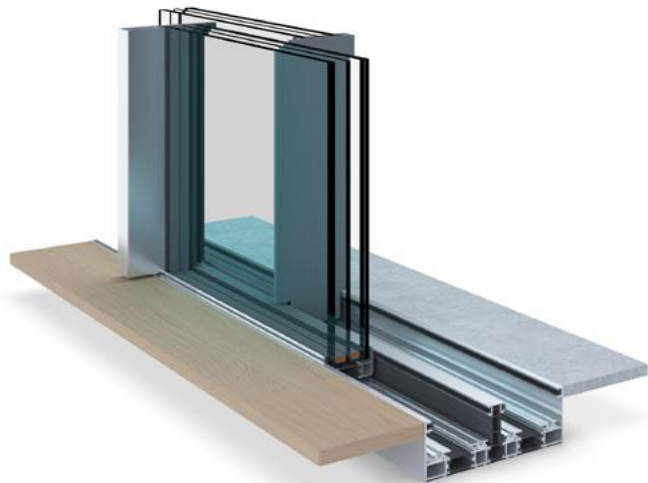

“ONE” model

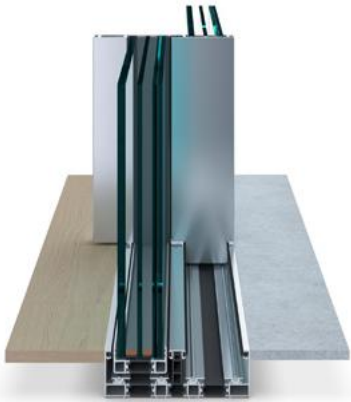

threshold for two opening doors

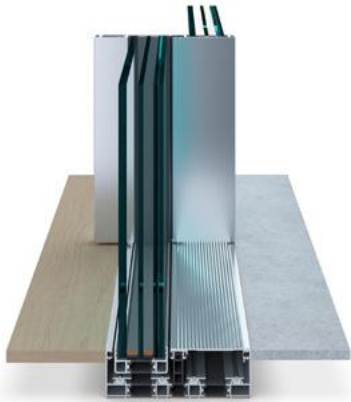

threshold for opening door with fixed sash



“ZERO” model



threshold for two doors with flush continuous intermediate floor

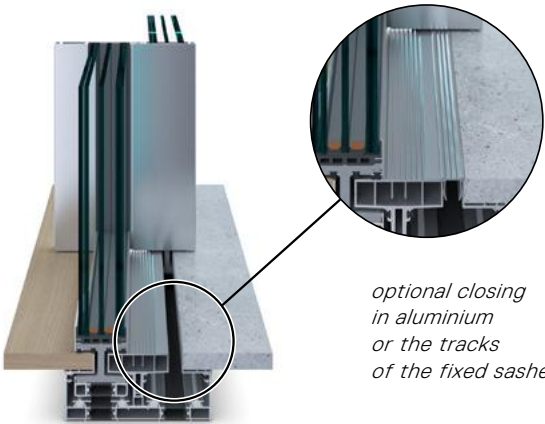

threshold for two doors with aluminium intermediate profile

optional closing in aluminium or the tracks of the fixed sashes



Configurations OMICRON and OMEGA

OMICRON



The Omicron configuration (from the Greek 'micro') is suitable for single glazing. Its space can range from 30mm to 36mm for the glass housing.

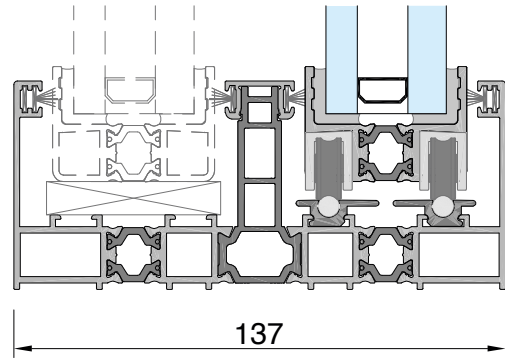

ΩMEGA



The Omega configuration (from the Greek 'mega') is suitable for double-glazing or thick single-glazing. Its space can range from 48mm to 54mm, for the glass housing.

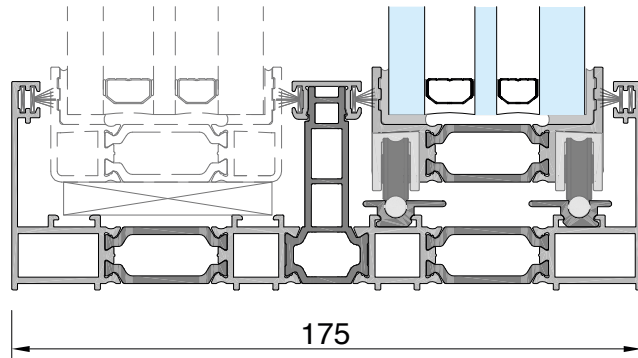

The configurations can be made in both the ONE and ZERO models.





Possible combinations

The Minimal Frame System by Agostini can give you infinite opening configurations by combining fixed doors with sliding ones, and vertical-pivot doors on single or multiple tracks, both in-view and concealed in the masonry or at a corner.

The dividing frame of the glazings is always the same size, also when combining the pivot and sliding types, to obtain a more harmonious and well-proportioned overall result for the window.

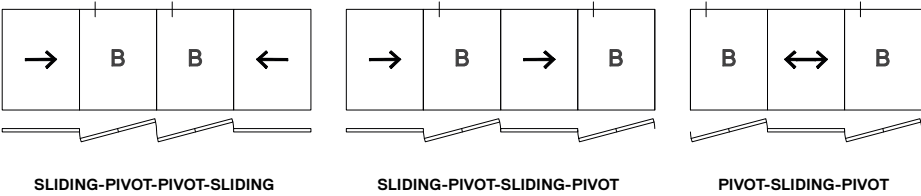
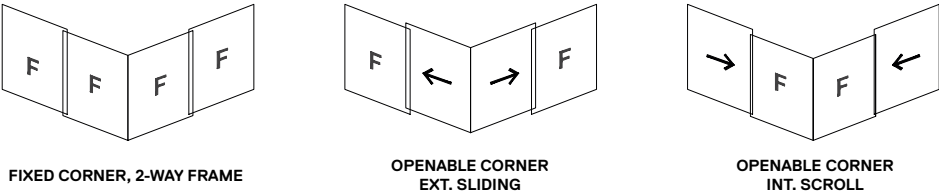
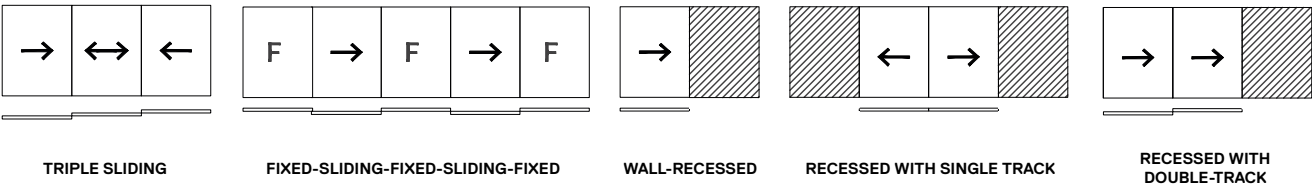
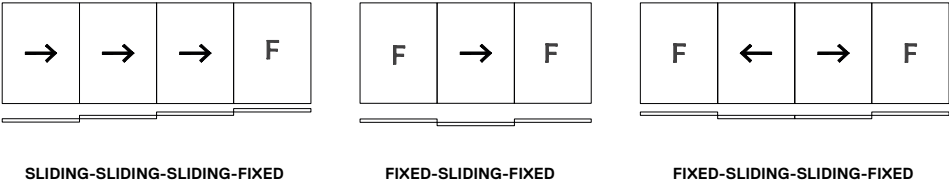
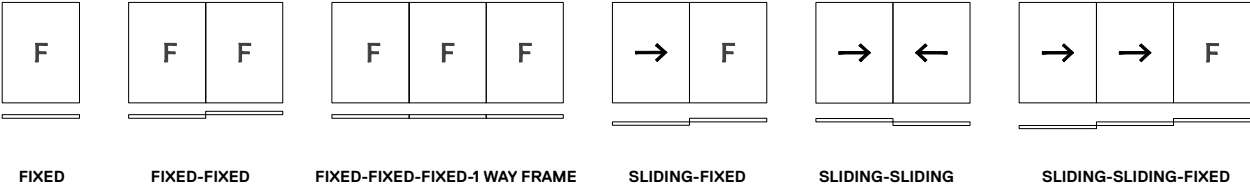







Finishes

Powder coatings are available in gloss or matt RAL colours, or with a rough surface effect (embossed), metallic colours, and wood-effect sublimated colours.

The colours indicated in this range are the ones most commonly used, however it is possible to create windows and doors in the whole variety of RAL colours and special colours.

The “wood effect” finish in aluminium is achieved by the sublimation process and not by the powder-on-powder process, which is cheaper but less realistic.

For systems subject to increased exposure to weather or sea-salt, seaside-protection treatment can be applied.

RAL MATT

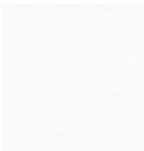

RAL 9010-OP
Matt White

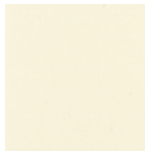

RAL 1013-OP
Matt ivory

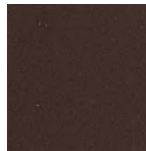

RAL 8017-OP
Matt Brown

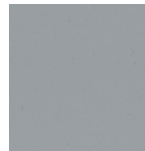

RAL 7001-OP
Matt Grey

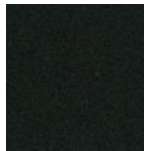

RAL 9005-OP
Matt black

RAL MATT RTX



Ral 9010 R TX
Embossed White

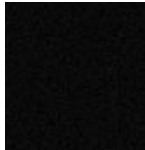

P9005 R TX
Embossed Black

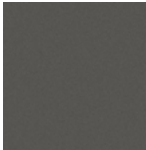

P 7022 R TX
Grey 7022 Embossed

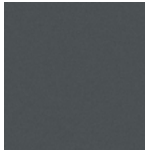

P 7016 R TX
Grey 7016 Embossed



P9007 R TX
Grey 9007 Embossed



P7006 R TX
Turtledove



SK13 SD
Brune Sablè



CRT
Cor-Ten

Sublimated colours



PK-A16
Cherry



PK-A18
Chestnut



PK-A10 9
Light Cherry



PK-A64
White Oak



PK-A72
Monument Oak



PK-MT11
Korten PF

Special Electrocolours



OX-A
Oxidized Silver



OX-B
Oxidized Bronze

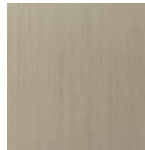

EL-AC
Brushed 206 Steel

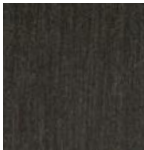

EL-NET
Black Elegance

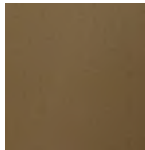

EL-BRT
Bronzo Tinex





Technical drawings

Horizontal sections 1:3

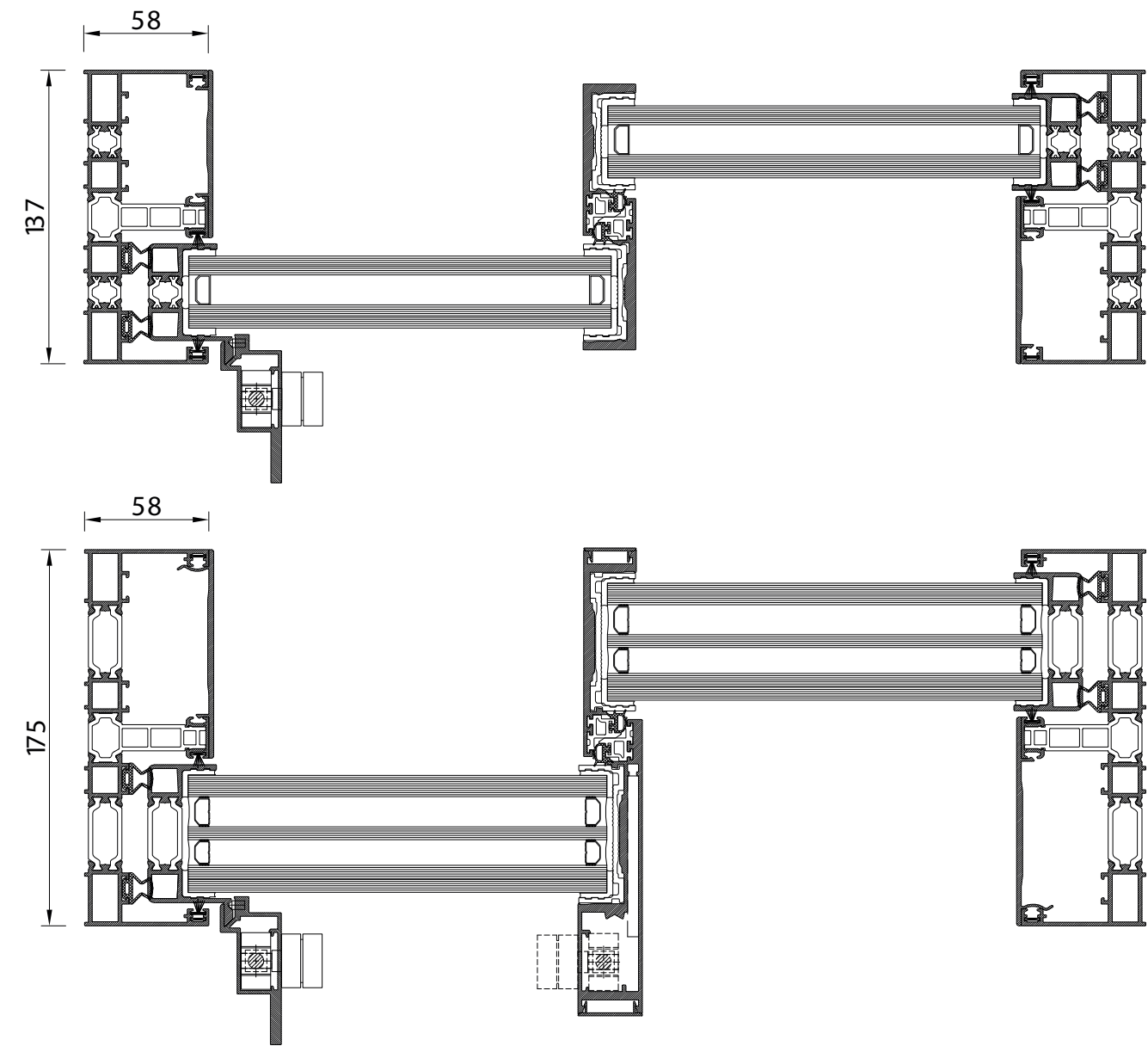

Omicron

Omega

Omicron

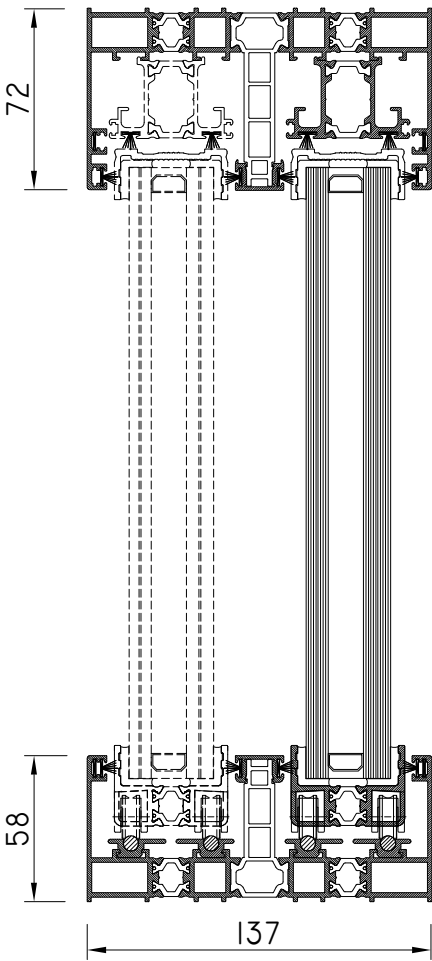

One solution

Zero solution

Omega

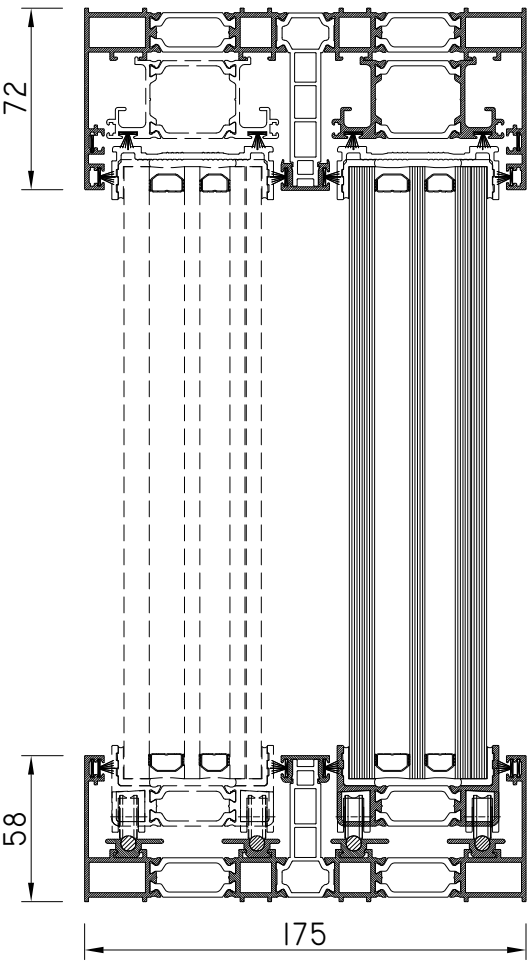

One solution

Zero solution

Technical drawings

Central nodes - frame structure 1:3

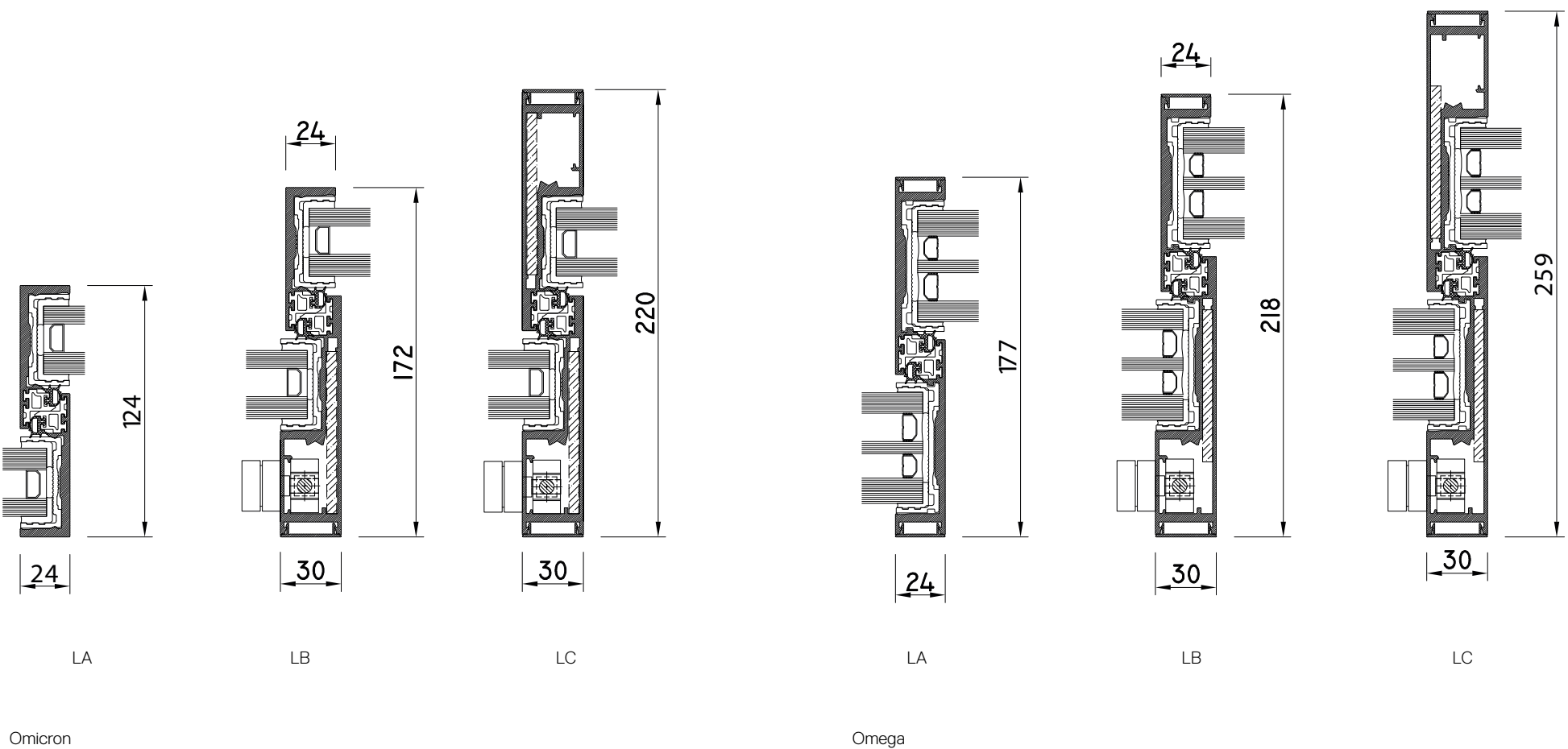

Central nodes - frame structure - Corner solutions 1:3

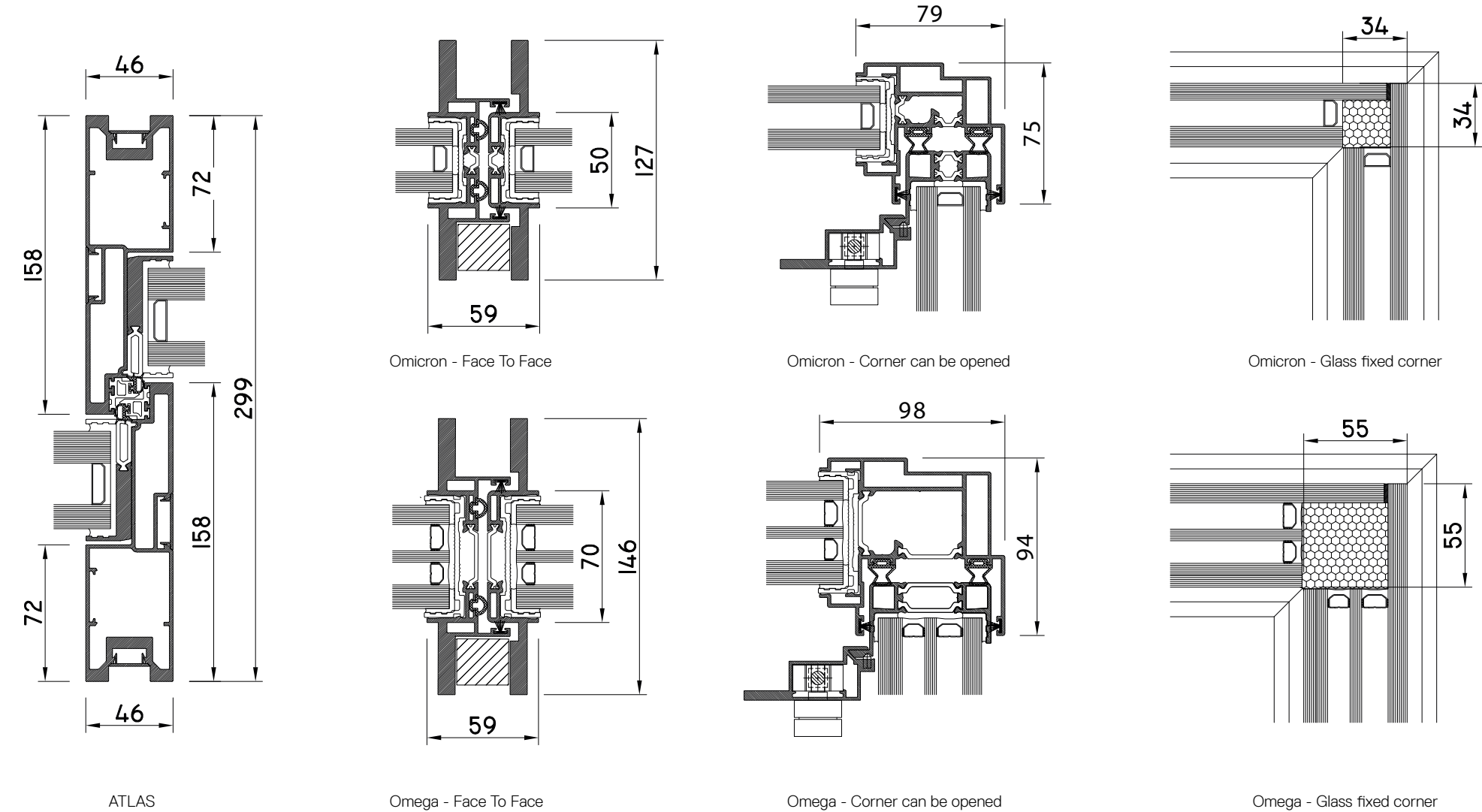

Technical drawings

Pocket - Horizontal section 1:3

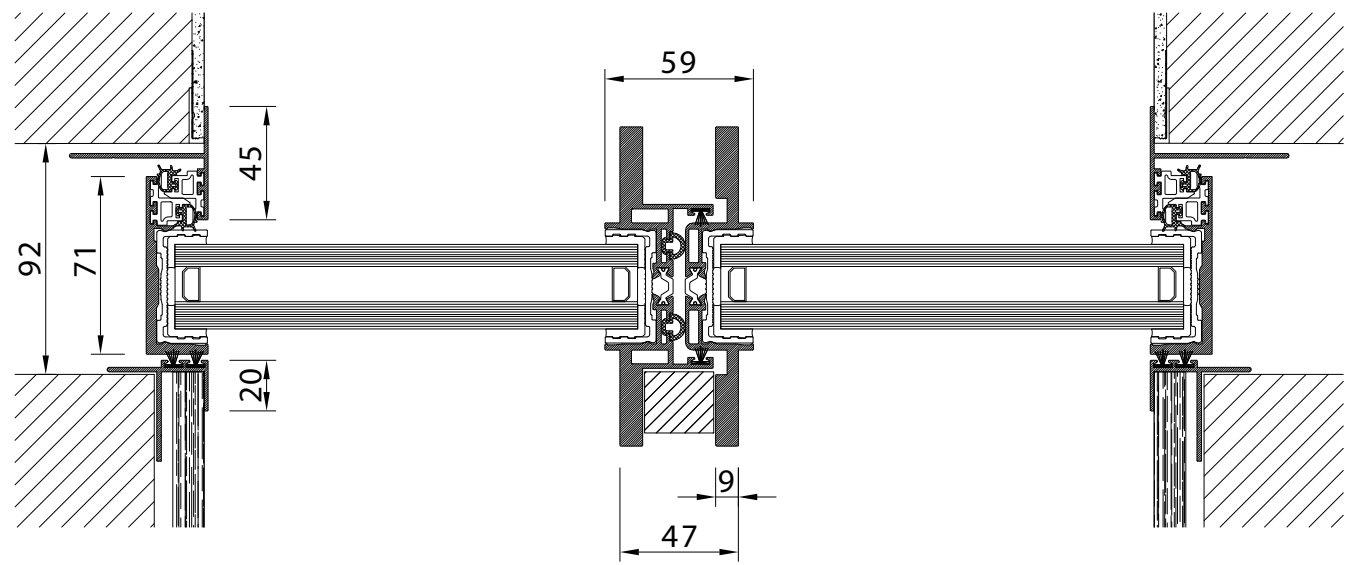

Omicron

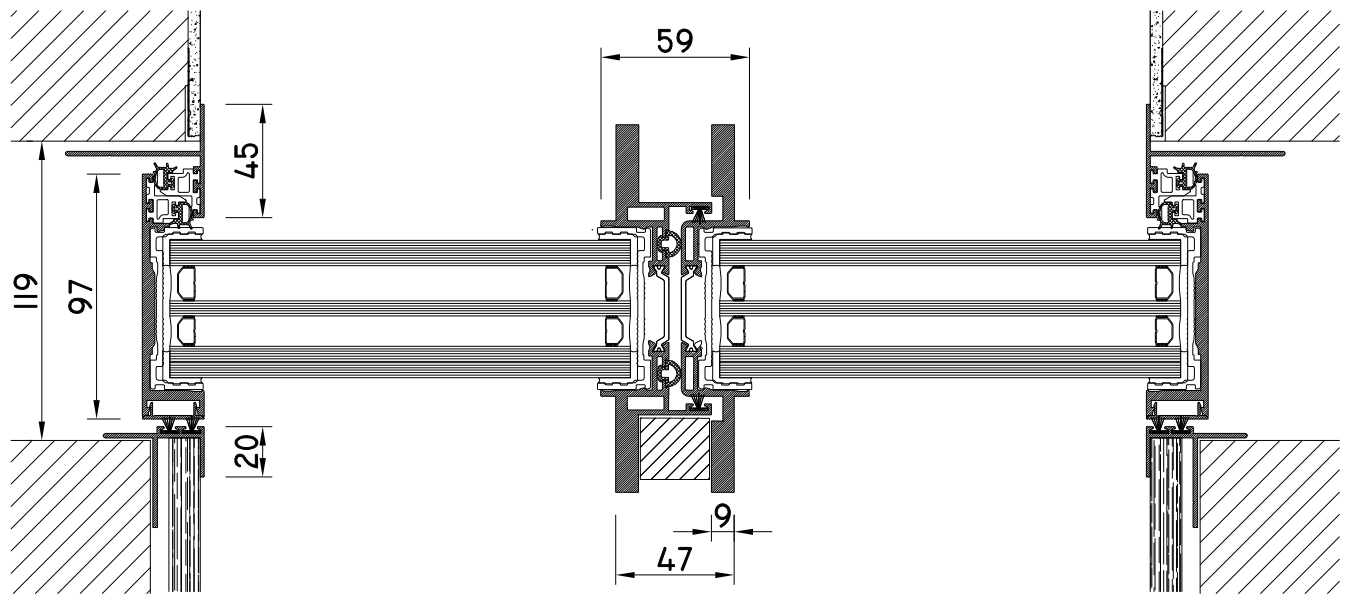

Omega

Technical drawings

Pivot horizontal section 1:3

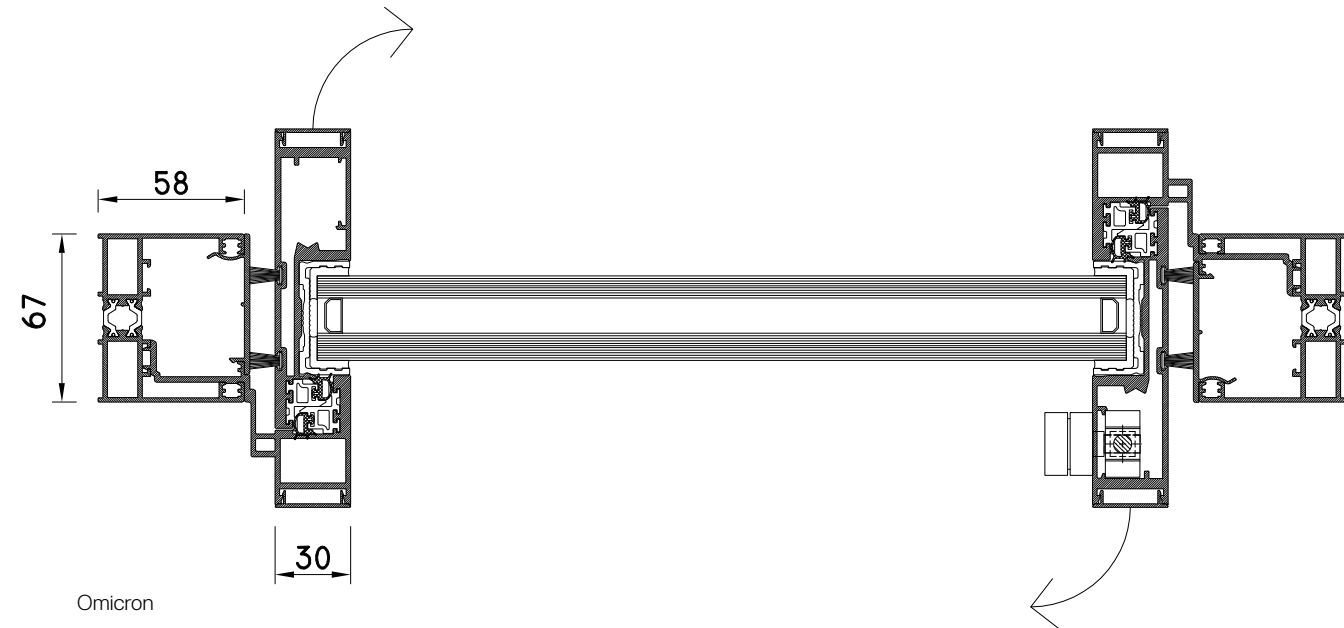

Omicron

Pivot vertical section 1:3

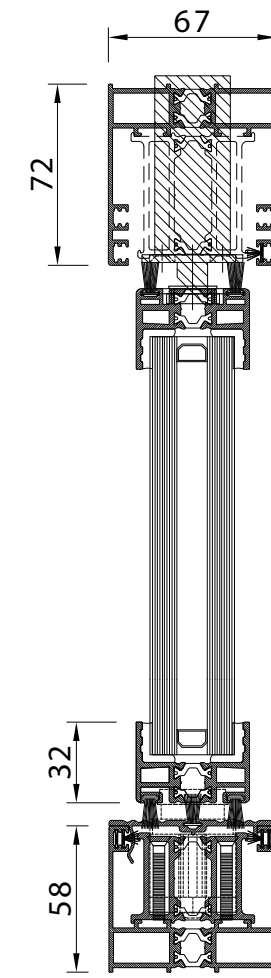

Omicron - One solution

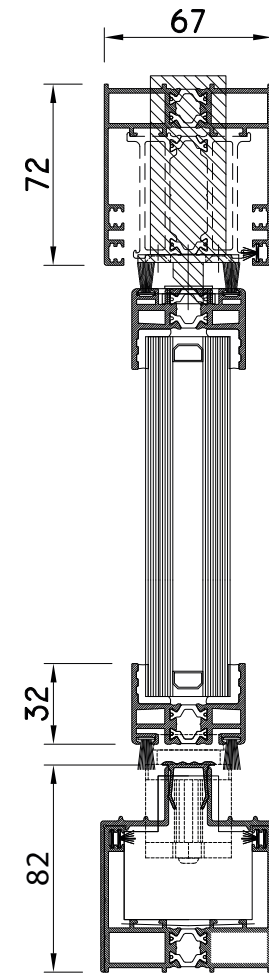

Omicron - Zero solution

Technical drawings

Lower node, One solution 1:3

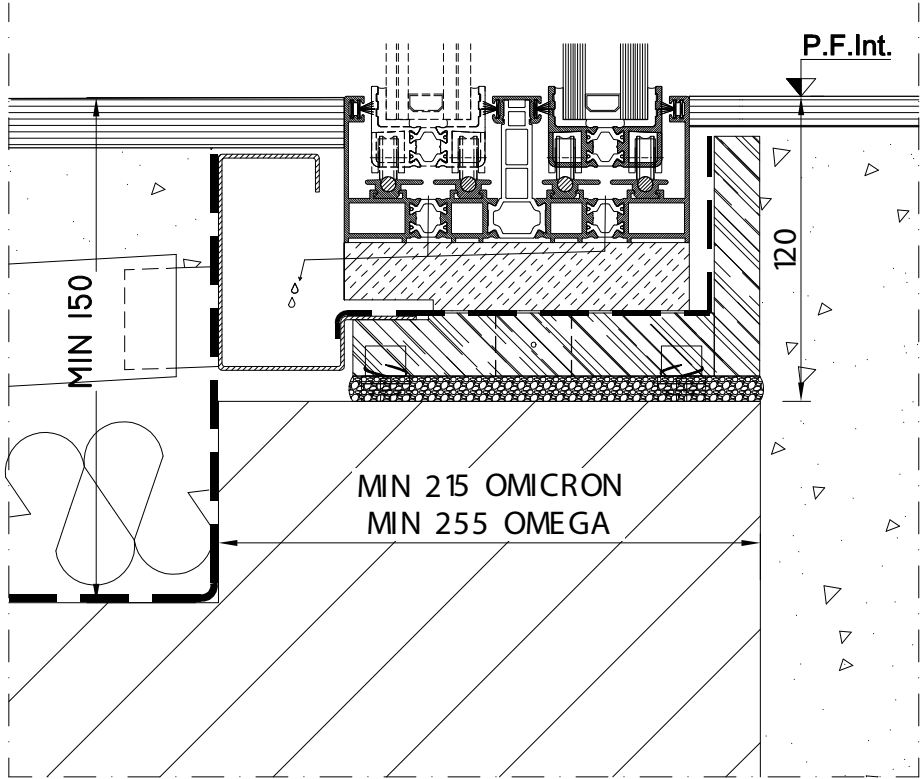

Water collection tray

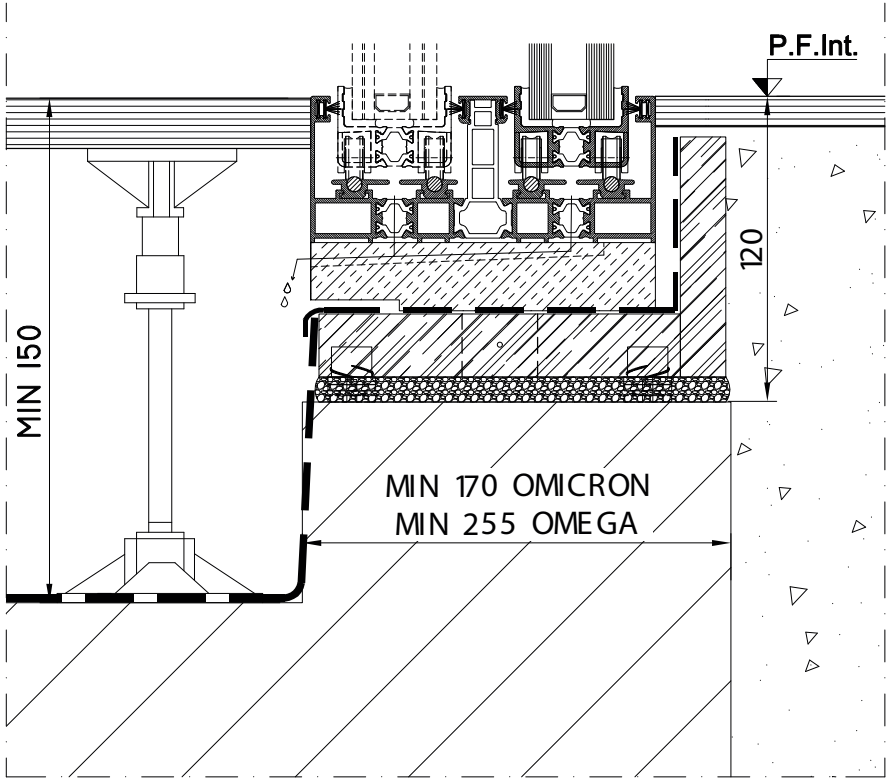

Floating floor

Lower node, Zero solution Scala 1:3

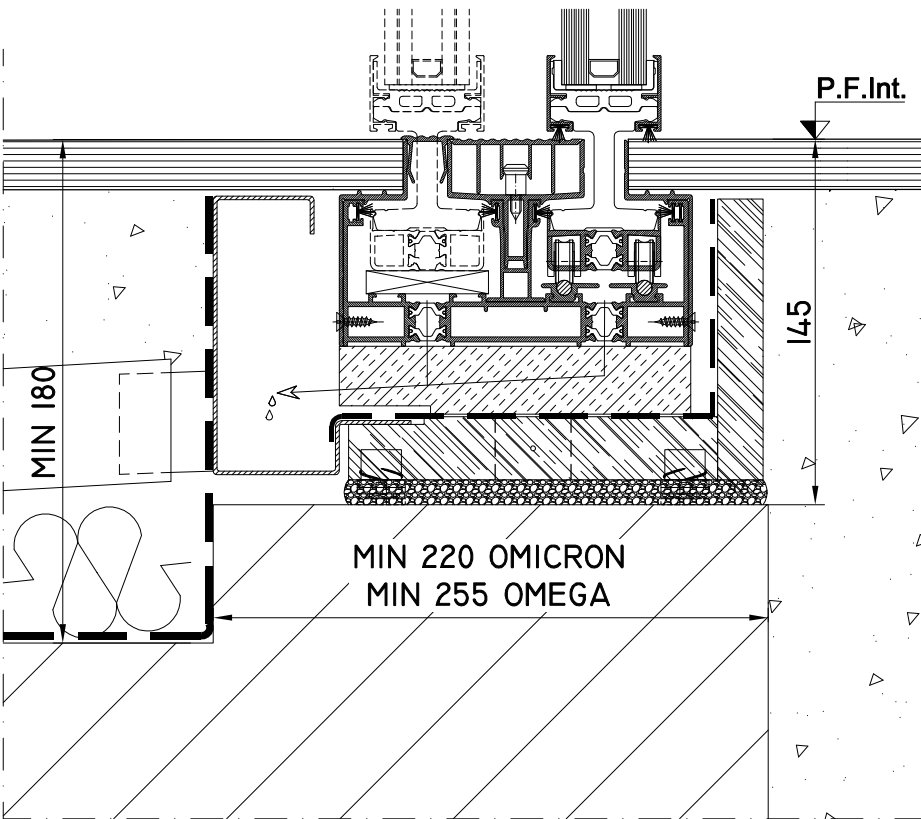

Water collection tray

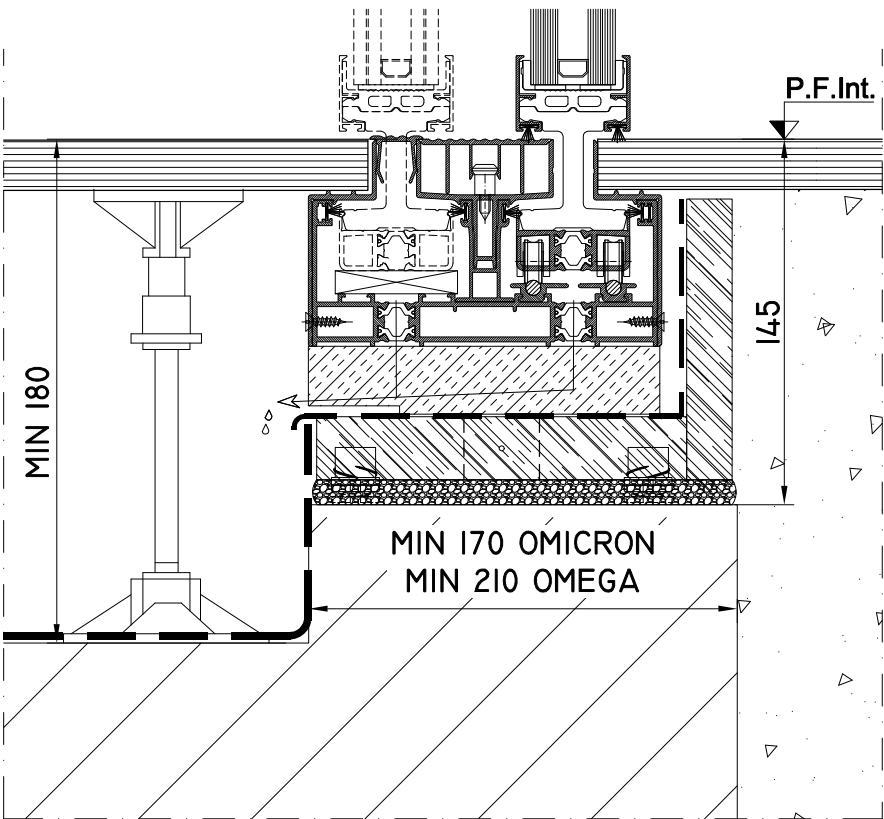

Floating floor

Technical drawings

Lower node with water drainage tray and grate 1:3

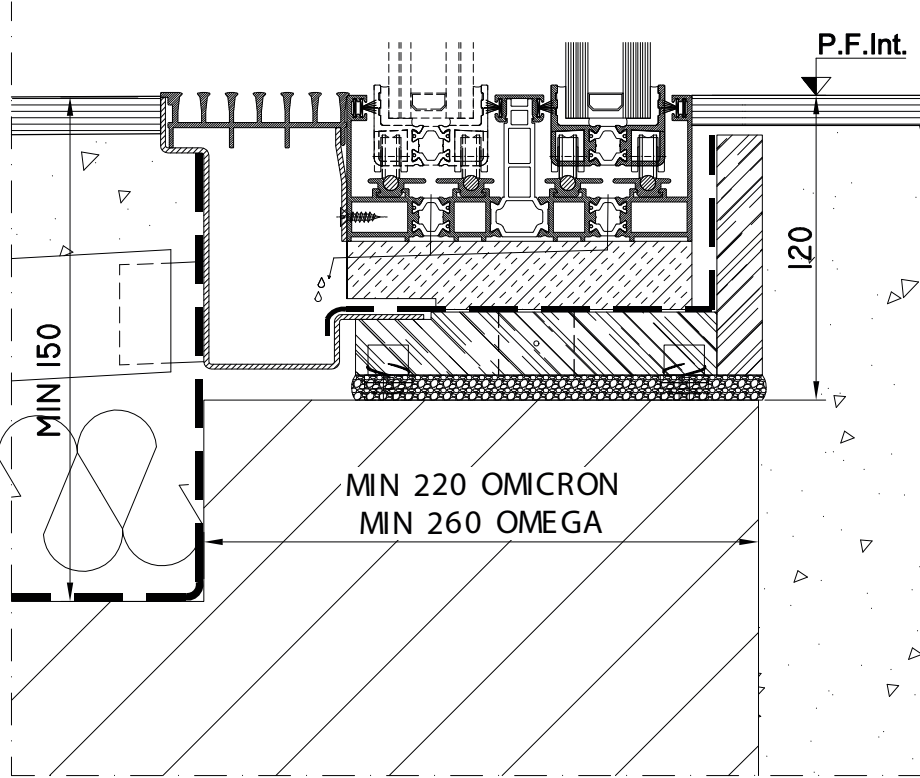

One solution

Glazing 1:3

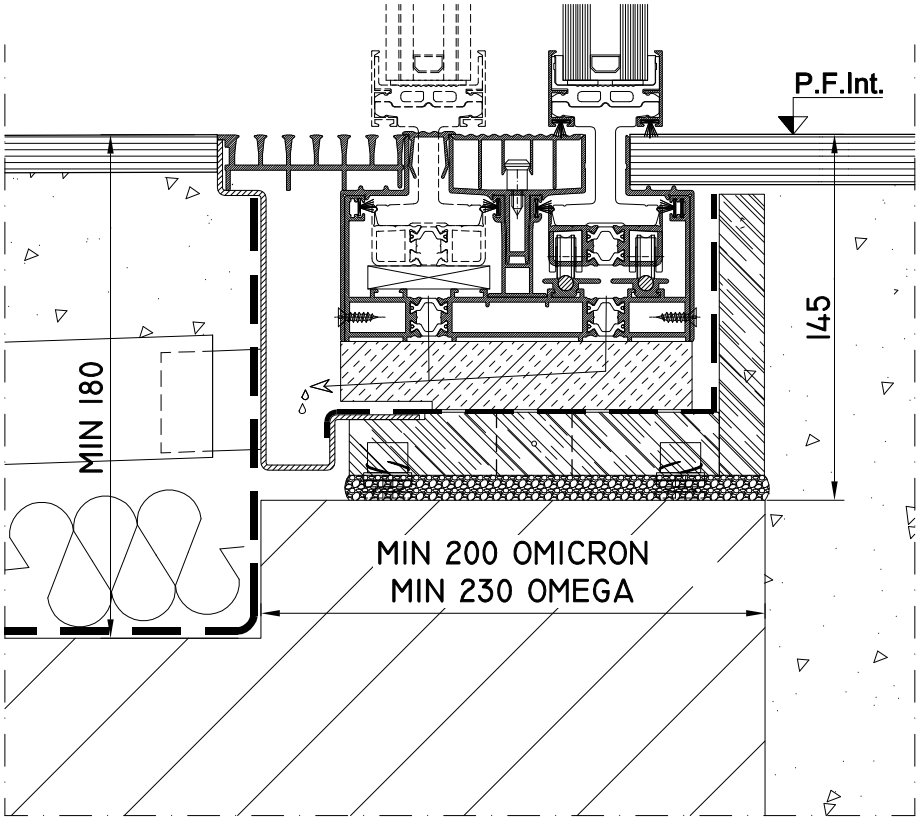

Zero solution

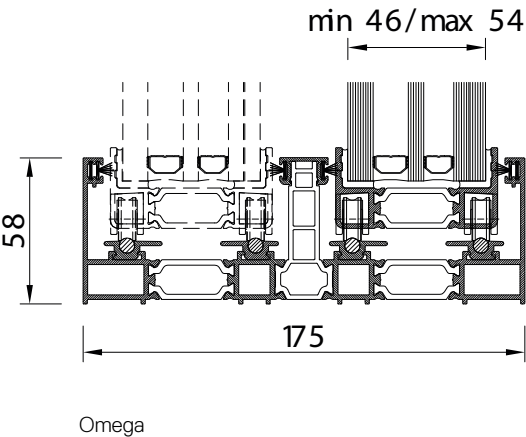
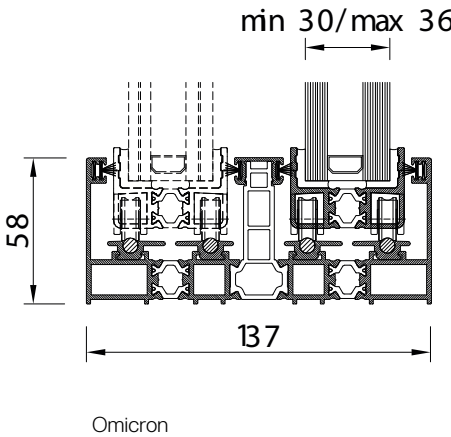

Agostini group, an illustrious history in innovating Italian windows and doors.

Over fifty years of innovative projects in the world of windows and doors, combining design and technology. Fifty years in which our mission has been to design and make windows and doors with always state-of-the-art materials and solutions, so as to keep improving the protection and insulation of our interiors while ensuring ideal energy savings with products of outstanding design. Our motto: “quality consistently high”, because our windows and doors really must last over time.

1963	Luciano Agostini founded his first company for the production of PVC shutters in the province of Venice. A revolution compared to the wooden shutters of the houses of the time.	2015	Inspired by Venice’s art masters, the ‘Fibex Inside Venice Collection’ series is born from the custom-made window models that can be customized in an infinite choice of material combinations, thus delivering frames suited to every architectural context and décor setting.
1984	The know-how gained in working with plastic materials leads the Agostini family business to teaming up with some of Europe’s leading system engineers and launch a line made of PVC - among the first in Italy.	2017	The Agostini Action Air “air exchange” system is presented, bringing cleaner and healthier environments, without wasting energy. The architecture design began for the new headquarters, which will host the new production plant and the Group’s new management offices.
1999	Agostini’s R&D team develops Fibex, one of the world’s first composites made from glass fibre to be used for shutters and blinds. The innovative system stems from working with US companies to meet the growing demand for materials that give high thermal and mechanical performance.	2019	Agostini presents its ‘minimal design solutions’ at Milan’s Made Expo, with the collections called Minimal Frame System and Zhero Frames Fibex Inside, window and door solutions designed to meet the new minimalist design trends.
2008	Agostini introduces the exclusive window and door system with ‘Fibex Inside’ technology, with aluminium and wood finishes that solve all of the sector’s thermal-insulation limitations.	2020	The ‘Agostini Minimal Frame’ solutions have been selected for the innovative Green Pea retail park in Turin as expressions of excellent Italian design of utmost respect for the environment and society.
2013	The Fibex Inside technology means that window and door frames can now be reduced considerably in size while retaining all of their thermal and acoustic insulation performance. Agostini introduces the models with the Total Glass finish.	2021	Launch and online publication of the websites agostiniminimal.com and minimalframes.it and social media to support the Digital Strategy dedicated to minimal doors and windows.

@agostinigroup
serramenti made in italy da oltre 50 anni

agostiniminimal.com

Agostini Group srl
Via G. Pascoli, 21
30020 Quarto d'Altino
Venezia, Italy
Tel +39 0422 7007
Fax +39 0422 700 799
info@agostinigroup.com